

CNW 70.2 Operating Instructions



Contact: Paslode Australia

Head Office
47 - 55 Williamson Road
Ingleburn
NSW 2565
Australia

www.paslode.com.au

Declaration of conformity

We declare that this product is in conformity with the following standards or other normative documents.

EN 292-1:1991; EN 22-2: 1995;

EN349:1993; EN 792-13:2001

Following the provision of EEC Directives

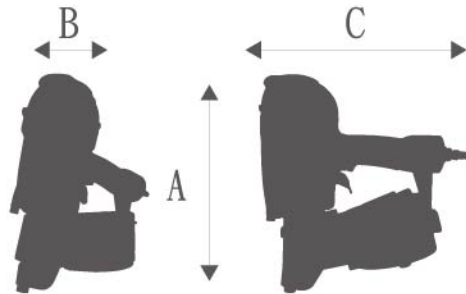

Technical Specifications

	Dimensions	CNW 70
Fastener Specification	Diameter	2.3 x 3.05mm
	Length (Wire)	38 - 70mm
	Length (Plastic)	32 - 70mm
Tool Weight		2.85kg
Dimensions	A	323mm
	B	127mm
	C	272mm
Air consumption		1.2 litre @ 90psi
Operating Pressure	Min - Max	4.8 - 7.6 bar
Load Capacity	Nails approx	250 - 400
	Max	110
Noise Level	L WA, 1s	99 dB (A)
	L pA, 1s	90 dB (A)
	LpA, 1s 1m	86 dB (A)
Vibration Value	a hwz	3.15 m/s ²

Normative Documents

EN 12549: 1999/2, EN ISO 8662-11: 1999

ITW Paslode - van Heemskerckweg 5; 5928 RB Venlo; The Netherlands.

Erik Mul - Design

Troubleshooting

Problem	Corrective Action
Fasteners not driven completely into wood	Increase air pressure (do not exceed maximum pressure as specified) Adjust Work Contacting Element. Remove No Mar
Fasteners driven too far below surface.	Reduce air pressure. Adjust Work Contacting Element. Add No Mar to the Work Contact Element
At higher driving speed, last fasteners in the magazine are not driven properly.	To increase air flow to tool, use larger air lines. Example: Change from 3/8" (10mm) to 1/2 " (13mm)
Fasteners jam in nose piece of tool.	Disconnect air supply. Clear the jam with the quick clear system or with a punch.
Tool operates, but no nail is driven.	Have fasteners been inserted properly into magazine? Adjust magazine where applicable for proper fastener length. Clean magazine. Check if correct fasteners are used.
Air leaks at cap, at silencer cap or nose piece.	Tighten screws at cap and nose piece.

In case you cannot solve the problems send your tool to your local service centre. Never work with a damaged tool. Repairs may be carried out by Paslode repair agents who have a thorough knowledge of pneumatic driving tools and who are able to judge the safe condition of the tool.

Daily Maintenance

- Before operating check for correct air pressure.
(see max. specified air pressure)
- Check before operating if correct fasteners are being used.
(Use ITW Paslode or Duo-Fast fasteners only as specified on data sheet.)
- Check that all bolts on tool are tight.
- Ensure that the work contacting element/safety yoke moves freely.
- Check for position of magazine including tightening of knobs, where appropriate.
- Keep magazine and feeder mechanism clean.
- Drain water separator daily.
- Clean air line filter and keep lubricator filled.
- Disconnect tool from air supply and empty magazine when job is completed.
- In case of any trouble, stop operating at once.

Following these steps ensures your safety, improves tool functioning and reliability.

Definition of parts

The pneumatic driving tool consists of 14 main parts.

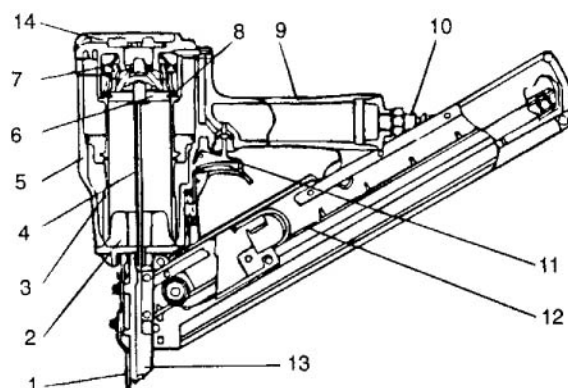

- 1 Work Contacting Element
- 2 Bumper
- 3 Cylinder
- 4 Driver
- 5 Housing
- 6 Piston
- 7 Main Valve
- 8 Sleeve Seal
- 9 Handle
- 10 Connecting nipple
- 11 Trigger
- 12 Magazine
- 13 Mouth (nose piece)
- 14 Cap

Tool functioning



1) Trigger 2) Work Contacting Element 3) Magazine

Pneumatic driving tools (apart from smaller, low powered tools without Work Contacting Element) are actuated by pulling the trigger (1), and depressing the safety yoke/work contacting element (2) when placing it on the work piece.

Releasing the trigger or lifting the tool from the work surface will allow piston return to start subsequent cycles. All nails, brads, and staples are fed automatically with the magazine.



Actuating system

The Work Contacting Element (2) prevents fasteners from being discharged freely.

Note:

Check operation of Work Contacting Element (2) daily, do not change or manipulate. When malfunctioning, have tool repaired by qualified service personnel only. The adjustable Work Contacting Element also allows for adjusting the driving depth of fasteners.

Different Actuation System (see relevant operating manual)

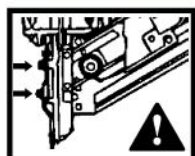

Adjustment of driven depth. Some tools are equipped with an adjustable safety yoke/work contacting element to regulate the driving depth. Disconnect tool from air supply prior to any adjustment. Only adjust within the specified limits. See Operating Manual.



Tools marked with an equilateral triangle pointed downwards may be used with Work Contacting Element.

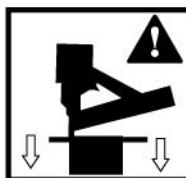

Watch your work place!

Fasteners may fire through the work piece and slide sideways through the work piece thus endangering people. Only operate when holding the tool on the work piece.



Check contents:

- Coil Nailing Tool
- Safety Glasses
- CNW 70 Operating Instructions
- No Mar Tip
- Hex Keys
- Carry Case

Prepare for use | Daily Maintenance



Prepare for use:

1. Smooth safety yoke movement
2. Trigger Movement
3. Worn or cracked handle
4. All screws and bolts are tight



Prepare for use | Compressor Pressure

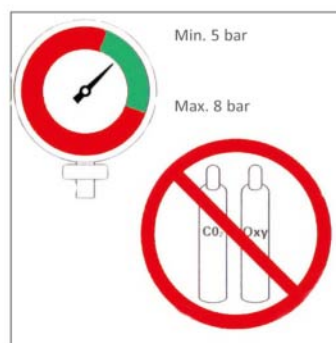

Carry the tool only by grasping the handle firmly without touching the trigger. Do not carry the tool by the hose or trigger



All tools should be fitted with quick release connectors, male plug must be fitted to the tool body. Use only brands that release pressure when supply is disconnected.

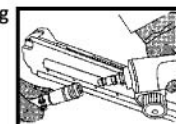

Always disconnect from compressed air supply before servicing, adjusting the tool, or clearing a jam.

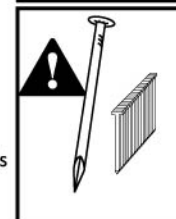

Fastener driving tools and fasteners must be regarded as a combined safety system.

For use only with timber to timber fixing or materials of similar or lesser density.

Prepare for use | Loading Nails

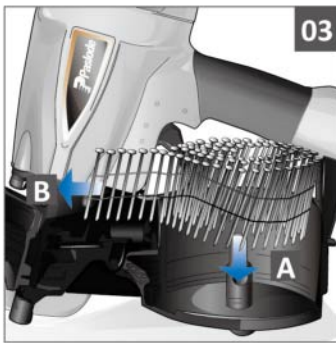
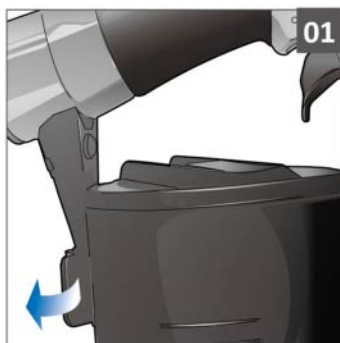

Compressor size, air distribution lines, air system maintenance, sufficient air supply and additional capacity will influence performance and fastening speed. Consult your ITW Paslode or Duo-Fast Representative.



The maximum air pressure, as specified for pneumatic ITW Paslode or Duo-Fast fastener tools, must not be exceeded.

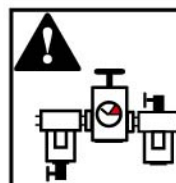

Use the minimum pressure required to achieve acceptable fix. The use of excessive pressure increases wear and sound levels. Only connect tools to lines where pressure is regulated and appropriate pressure relief valves are installed. Each take off point on the main line should be fitted with a filter – regulator – lubricator. Filters should be of the “auto drain” type or alternatively be manually drained on a daily basis. For compressed air lines without lubrication, an “in-line” lubricator should be fitted to the tool or manually lubricated directly into the tool air inlet.

Prepare for use | Adjusting the depth adjuster

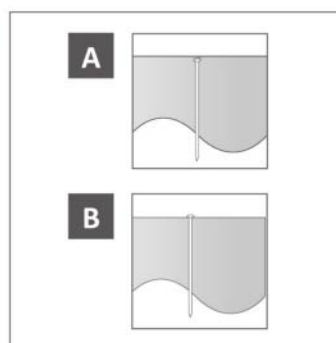
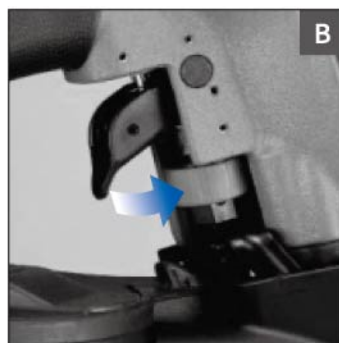
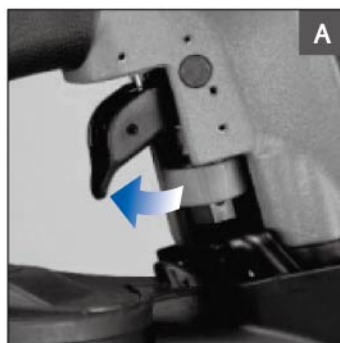

The diameter of the air distribution line must be sufficient. The air pressure drop when driving fasteners should not exceed 0.5 bar. The hose should be as short as possible, as a long hose could cause obstructions and a drop in air pressure. The minimum diameter required for the hose is 10mm (3/8”), 13mm (1/2”) for larger tools. For further details about air consumption and other technical data, please see attached data sheet.



Periodically, check tension of all nuts and bolts on the tool. Maintenance should only be carried out by competent persons.

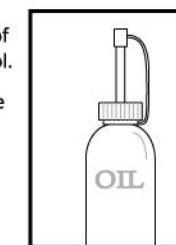

Keep the tool clean and properly lubricated. If the tool is not equipped with a lubricator, inject daily some drops of special Paslode or Duo-Fast oil through the air connector (into the air intake opening).

Pneumatic Fastener Driving Tools



Read the General Safety Operating Manual carefully before using your new tool.

Congratulations on buying an ITW Paslode or Duo-Fast quality product! Your ITW Paslode or Duo-Fast Tool will operate to your satisfaction for a long time if handled correctly and if all safety instructions are observed. Use ITW Paslode or Duo-Fast specified fasteners and spare parts only.

Safety Rules for Pneumatic Tools

Observe the safety instructions manual carefully!

Failure to follow all safety instructions may result in severe injury to yourself or somebody else. Also, follow the maintenance instructions. Use Paslode or Duo-Fast specified fasteners and spare parts only. Paslode or Duo-Fast shall, in no event, be liable for the non-observation of these instructions.



Approved eye protection must be worn at all times by tool operators, and is recommended for persons working in the area where tools are being used.



Always wear hearing protection when operating tools, or when working in the vicinity of tools being used.



Never connect a tool to a bottled gas supply. Use only filtered, regulated, lubricated, compressed air.



For intricate fastening and accurate tool placement, i.e. when tool positioning requires the use of ladders, scaffolding, etc, when working close to edges, when closing cases and boxes, when fitting transportation actuating systems, it is required to use the sequential activating trigger method.



Use the tool only for intended application. Never engage in horseplay with the tool.



Keep your hand clear of nose piece when operating tools.



Keep portable fastener tools away from children and unauthorized persons



Do not weaken or damage the tool housing by punching or engraving. Be aware that the tool housing is a pressure vessel.



When operating, keep the tool away from your head and body to prevent injury by a kick back of the tool caused, for instance, by an air supply problem or hard spots in the work piece.



No tool modifications are permitted

When loading the tool, do not operate trigger or safety yoke/work contacting element. When using a tool for the first time, fill magazine after connecting it to air line system.



Clearing a jam
Always disconnect from compressed air supply

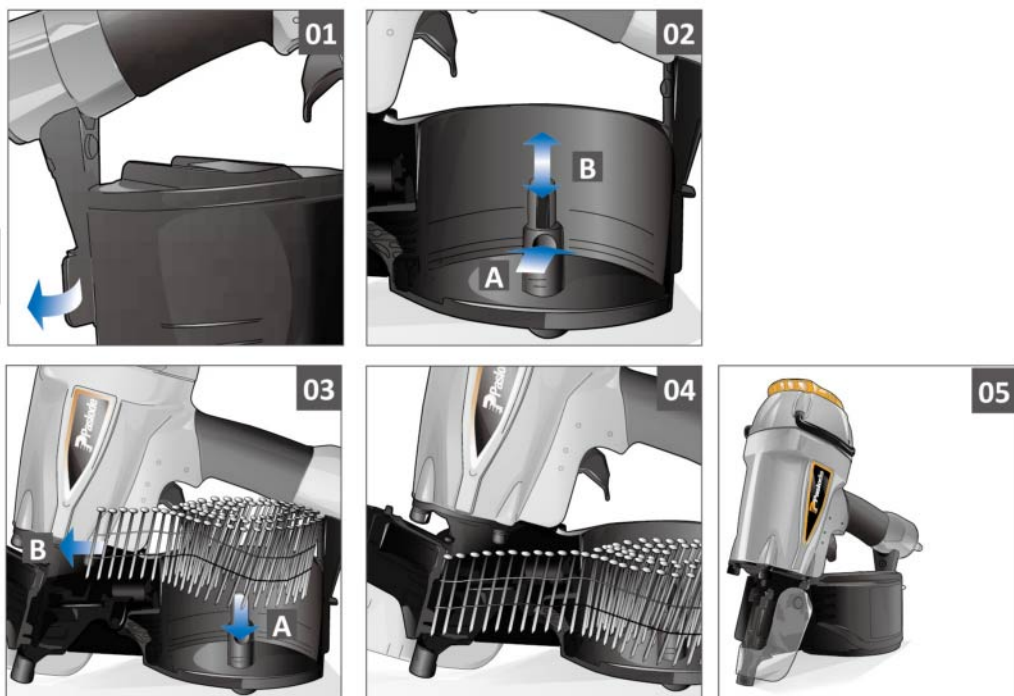
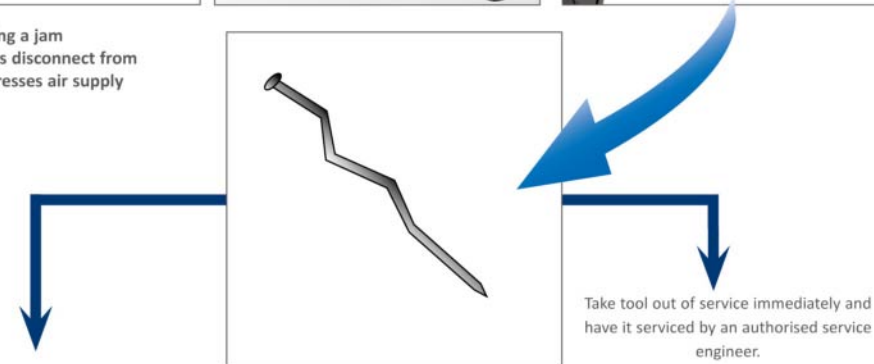

Parts List

CNW70.2

REF	PART No	DESCRIPTION	Qty
1	613001	FLAT HD. BOLT M6X20	1
2	613002	FRONT BRACKET	1
3	613003	EXHAUST COVER	1
4	613004	EXHAUST FILTER	1
5	613005	EXHAUST FILTER PLATE	1
6	623149	HEX.SOC.HD.BOLT	4
7	613007	CAP	1
8	613008	SPRING	1
9	613009	WASHER	1
10	613010	O-RING*	1
11	613011	PISTON HEAD VALVE	1
12	613012	O-RING*	1
13	613013	SEAL	1
14	613014	PLAIN WASHER	1
15	613015	PISTON STOPPER	1
16	613016	O-RING*	1
18A	613017	DRIVER ASSY*	1
19	613018	CYLINDER	1
20	613019	O-RING*	1
21	613020	CYLINDER RING	1
22	613021	COLLAR	1
23	613022	O-RING*	1
24	613023	GASKET	1
25	613024	BODY	1
27	613026	BUMPER*	1
28	613027	O-RING	1
29	613029	O-RING*	1
30	613200	NOSE	1
31	405312	HEX.SOC.HD.BOLT	4
32	613033	STEPPED PIN	1
33	613034	RETAIN RUBBER	1
34	613047	RETAIN RUBBER	3
35	613048	CHECK PAWL	2
36	613049	SPRING	1
37	613050	STEPPED PIN	1
38	613202	E-RING	1
39	613046	FEED PAWL	1
40	613044	STEPPED PIN	1
41	613036	O-RING*	1
42	613037	FEED PISTON	1
43	613038	O-RING*	1
44	613039	SPRING	1
45	613040	SPRING	1
46	613041	FEED PISTON STOP	1
47	613042	SPRING COLLAR	1

REF	PART No	DESCRIPTION	Qty
48	613043	C RING	1
49	613073	STEPPED PIN	1
50	613074	RATCHET	1
51	613045	SPRING	2
52A	613205	GATE ASSEMBLY	1
53A	613066	NAIL SUPPORT	1
54	613067	SPRING	1
55	613068	SET SHAFT	1
56A	613069	SLIDE ROD	1
57	613206	MAGAZINE	1
58	613071	UM.HD.BOLT	1
59	166063	HEX.SOC.HD.BOLT	1
60	613207	LOCK NUT M5	1
61	613208	MAGAZINE COVER	1
62	400828	ROLLED PIN	2
63	613064	RUBBER INSERT	3
64	613210	SAFETY LEVER	1
65	613063	DUST COVER	1
66	070545	FLAT WASHER	2
67A	613211	ADJUSTING BOLT	1
68	613062	NOSE COVER	1
69	613212	SPRING	1
70	613139	ROLLED PIN	1
71	613028	RUBBER GRIP	1
72	613031	ROLLED PIN	4
78	613025	O-RING	1
82A	613124	SWITCH ASSY*	1
86A1	613095	SEQUENTIAL TRIGGER ASSY (GREY)	1
86A1	613096	BUMP FIRE TRIGGER	1
90	613214	TRIP GUIDE	1
91	613215	SET SHAFT	1
92	613216	CONTACT TRIP BLOCK	1
94	613006	PROTECTOR	2
96	613217	O-RING	1
98	613060	SPRING	1
99	613218	COVER	1
102	615942	UM.HD.BOLT	1
103A	613065	NAIL ADJ. SUPPORT	1
104	613219	STEPPED PIN	1
105	613220	SPRING	1
106	613221	DOOR LOCK	1
108	613222	ROLLED PIN	1
109	613223	ADJUSTING WHEEL	1
111	613224	HOOK	1
112	613225	HOOK PLATE	1

> Denotes Part Change

* Denotes Wear item

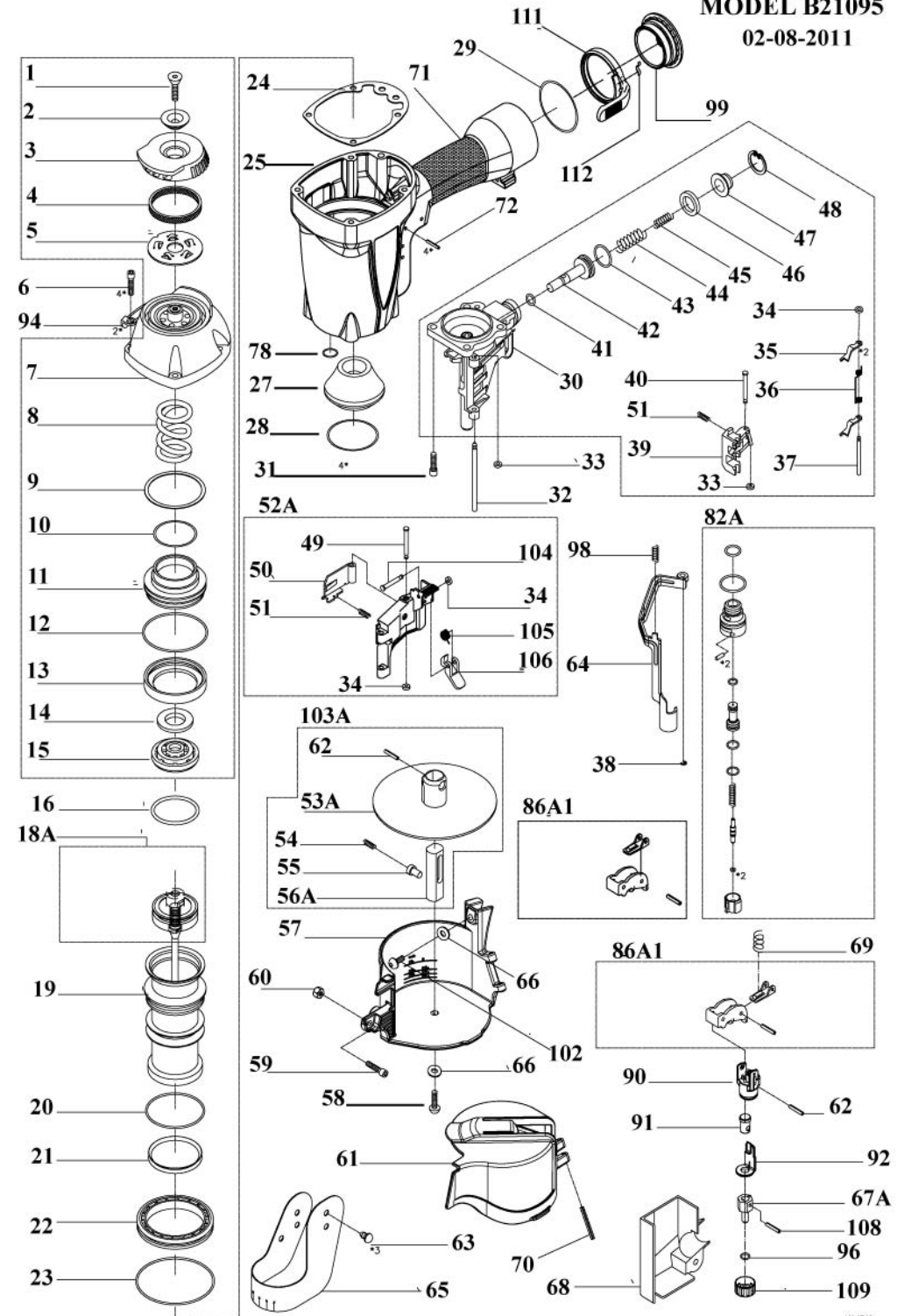

For more information on this product visit

www.paslode.com.au

or speak to your local Paslode distributor

